

Ropner Park

ROAD AHEAD CLOSED

ROAD CLOSED

URBAN CLEARWAY No Stopping  
6pm Sat 27th - 1pm Sun 28th Sept

URBAN CLEARWAY No Stopping  
6pm Sat 27th - 1pm Sun 28th Sept

URBAN CLEARWAY No Stopping  
6pm Sat 27th - 1pm Sun 28th Sept

URBAN CLEARWAY No Stopping  
6pm Sat 27th - 1pm Sun 28th Sept

URBAN CLEARWAY No Stopping  
6pm Sat 27th - 1pm Sun 28th Sept

URBAN CLEARWAY No Stopping  
6pm Sat 27th - 1pm Sun 28th Sept

URBAN CLEARWAY No Stopping  
6pm Sat 27th - 1pm Sun 28th Sept

URBAN CLEARWAY No Stopping  
6pm Sat 27th - 1pm Sun 28th Sept

URBAN CLEARWAY No Stopping  
6pm Sat 27th - 1pm Sun 28th Sept

**URBAN CLEARWAY No Stopping**  
29  
6pm Sat 27th - 1pm Sun 28th Sept

**URBAN CLEARWAY No Stopping**  
30  
6pm Sat 27th - 1pm Sun 28th Sept

**Reproduction & Copyright Notice**  
 © Hatton Traffic Management Limited 2025.  
 This document is the intellectual and physical property of Hatton Traffic Management Limited.  
 All forms of reproduction are strictly prohibited without the prior approval of the author. Forwarding to third parties or use of this drawing by a third party without the prior approval of the author is prohibited. Unauthorised reproduction or use may lead to prosecution or civil proceedings. Hatton Traffic Management Limited reserve the right to seek reparation for infringement or loss of income.  
 Use of digital mapping is by kind permission of Ordnance Survey Crown Copyright © Under the contractors use scheme.  
 Freedom of Information Act  
 This document contains confidential and proprietary information. Unauthorised disclosure, copying or editing is prohibited. Information contained within is exempt from sharing under 54(2) of the Freedom of Information Act.

**URBAN CLEARWAY**  
No Stopping  
Except Buses  
**6pm Sat 27th - 8am  
Sun 28th Sept**

**26**

**URBAN CLEARWAY**  
No Stopping  
Except Buses  
**6pm Sat 27th - 8am  
Sun 28th Sept**

**URBAN CLEARWAY**  
No Stopping  
Except Buses  
**6pm Sat 27th - 8am  
Sun 28th Sept**

**URBAN CLEARWAY**  
No Stopping  
Except Buses  
**6pm Sat 27th - 8am  
Sun 28th Sept**

**URBAN CLEARWAY**  
No Stopping  
Except Buses  
**6pm Sat 27th - 8am  
Sun 28th Sept**

**URBAN CLEARWAY**  
No Stopping  
Except Buses  
**6pm Sat 27th - 8am  
Sun 28th Sept**

**URBAN CLEARWAY**  
No Stopping  
Except Buses  
**6pm Sat 27th - 8am  
Sun 28th Sept**

**URBAN CLEARWAY**  
No Stopping  
Except Buses  
**6pm Sat 27th - 8am  
Sun 28th Sept**

**URBAN CLEARWAY**  
No Stopping  
Except Buses  
**6pm Sat 27th - 8am  
Sun 28th Sept**

**URBAN CLEARWAY**  
No Stopping  
Except Buses  
**6pm Sat 27th - 8am  
Sun 28th Sept**

**URBAN CLEARWAY**  
No Stopping  
Except Buses  
**6pm Sat 27th - 8am  
Sun 28th Sept**

**Reproduction & Copyright Notice**  
©Hatton Traffic Management Limited 2025.  
This document is the intellectual and physical property of Hatton Traffic Management Limited.  
All forms of reproduction are strictly prohibited without the prior approval of the author. Forwarding to third parties or use of this drawing by a third party/alternative contractor or authority is prohibited. Unauthorised reproduction or use may lead to prosecution or civil proceedings. Hatton Traffic Management Limited reserve the right to seek reparation for infringement or loss of income.  
Use of digital mapping is by kind permission of Ordnance Survey Crown Copyright © Under the contractors use scheme.  
**Freedom of Information Act**  
This document contains confidential and proprietary information. Unauthorised disclosure, copying or editing is prohibited. Information contained within is exempt from sharing under S43(2) of the Freedom of Information Act.

**HATTON**  
TRAFFIC MANAGEMENT  
Unit 10b, Brunswick Industrial Estate  
Brunswick Village,  
Newcastle Upon Tyne NE13 7BA  
Tel: 0191 2368060 Fax: 0191 2362035  
andrewross@hattontraffic.co.uk

**Project Details :**  
Stockton and Darlington Railway  
200 Event  
Clearway on Approaches to Level  
Crossing at Allens West

**Client:** Stockton Darlington and Durham Councils  
**Project:** Stockton and Darlington Railway 200 Event  
**Drawn By:** Andrew Ross  
**Checked By:** Wayne Robinson  
**Date:** 5th June 2025  
**Drawing Reference No:**  
4007/25/215/AR12.1 Day 3 Ref 12

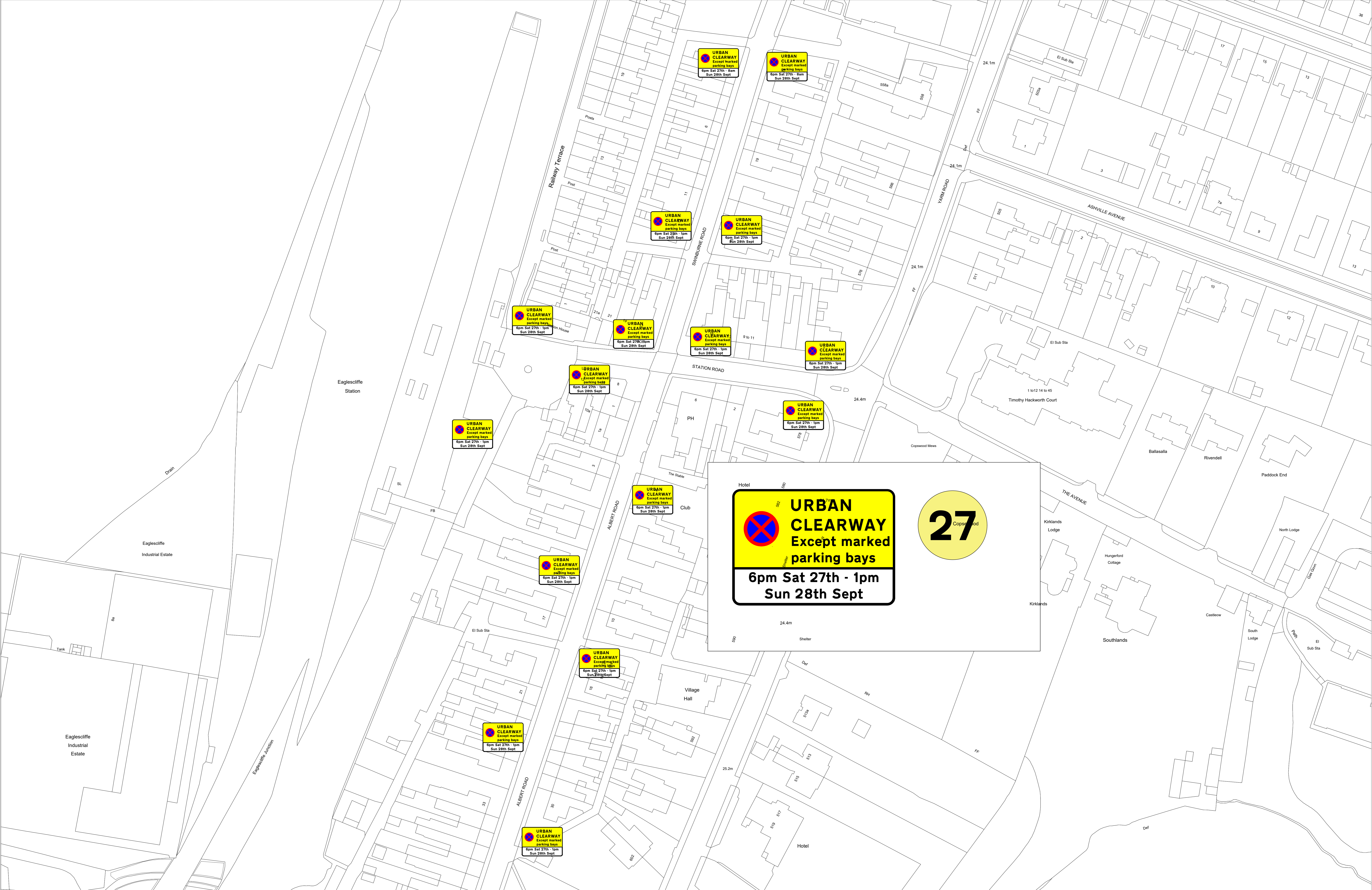

**Reproduction & Copyright Notice**  
 ©Hatton Traffic Management Limited 2025.  
 This document is the intellectual and physical property of Hatton Traffic Management Limited.  
 All forms of reproduction are strictly prohibited without the prior approval of the author. Forwarding to third parties or use of this drawing by a third party/alternative contractor or authority is prohibited. Unauthorised reproduction or use may lead to prosecution or civil proceedings. Hatton Traffic Management Limited reserve the right to seek reparation for infringement or loss of income.  
 Use of digital mapping is by kind permission of Ordnance Survey Crown Copyright © Under the contractors use scheme.  
**Freedom of Information Act.**  
 This document contains confidential and proprietary information. Unauthorised disclosure, copying or editing is prohibited. Information contained within is exempt from sharing under S43(2) of the Freedom of Information Act.

**HATTON**  
 TRAFFIC MANAGEMENT  
 Unit 10b, Brunswick Industrial Estate  
 Brunswick Village,  
 Newcastle Upon Tyne NE13 7BA  
 Tel: 0191 2368060 Fax: 0191 2362035  
 andrewross@hattontraffic.co.uk

**Project Details :**  
 Stockton and Darlington Railway  
 200 Event  
 Clearway of roads adjacent to  
 Eaglescliffe Station; Station Road,  
 Swinburne Road, Albert Road

**Client:** Stockton Darlington and Durham Councils  
**Project:** Stockton and Darlington Railway 200 Event  
**Drawn By:** Andrew Ross  
**Checked By:** Wayne Robinson  
**Date:** 5th June 2025  
**Drawing Reference No:**  
 4007/25/215/AR14.1 Day 3 Ref 14



**Reproduction & Copyright Notice**  
 ©Hatton Traffic Management Limited 2025.  
 This document is the intellectual and physical property of Hatton Traffic Management Limited. All forms of reproduction are strictly prohibited without the prior approval of the author. Forwarding to third parties or use of this drawing by a third party/alternative contractor or authority is prohibited. Unauthorised reproduction or use may lead to prosecution or civil proceedings. Hatton Traffic Management Limited reserve the right to seek reparation for infringement or loss of income.  
 Use of digital mapping is by kind permission of Ordnance Survey Crown Copyright © Under the contractors use scheme.  
**Freedom of Information Act**  
 This document contains confidential and proprietary information. Unauthorised disclosure, copying or editing is prohibited. Information contained within is exempt from sharing under S43(2) of the Freedom of Information Act.

**HATTON**  
 TRAFFIC MANAGEMENT  
 Unit 10b, Brunswick Industrial Estate  
 Brunswick Village,  
 Newcastle Upon Tyne NE13 7BA  
 Tel: 0191 2368060 Fax: 0191 2362035  
 andrewross@hattontraffic.co.uk

**Project Details :**  
 Stockton and Darlington Railway  
 200 Event  
 Closure of A67 from roundabout at Mill Lane east to new roundabout at junction with new airport access road.

**Client:** Stockton Darlington and Durham Councils  
**Project:** Stockton and Darlington Railway 200 Event  
**Drawn By:** Andrew Ross  
**Checked By:** Wayne Robinson  
**Date:** 5th June 2025  
**Drawing Reference No:** 4007/25/215/AR06.1 Day 3 Ref 6,7,8,9 &10

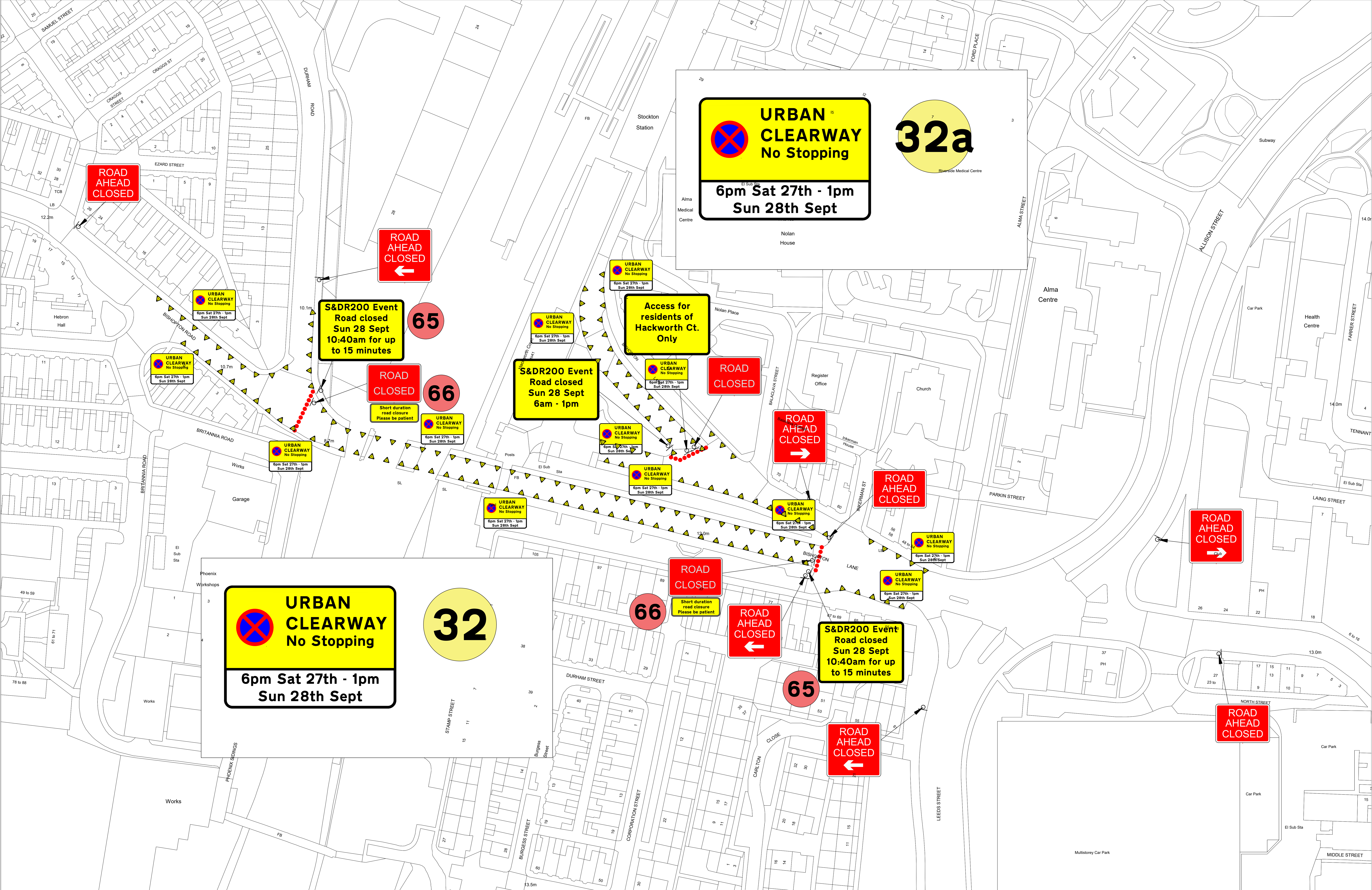

**Reproduction & Copyright Notice**  
 ©Hatton Traffic Management Limited 2025.  
 This document is the intellectual and physical property of Hatton Traffic Management Limited. All forms of reproduction are strictly prohibited without the prior approval of the author. Forwarding to third parties or use of this drawing by a third party/alternative contractor or authority is prohibited. Unauthorised reproduction or use may lead to prosecution or civil proceedings. Hatton Traffic Management Limited reserve the right to seek reparation for infringement or loss of income.  
 Use of digital mapping is by kind permission of Ordnance Survey Crown Copyright © Under the contractors use scheme.  
**Freedom of Information Act.**  
 This document contains confidential and proprietary information. Unauthorised disclosure, copying or editing is prohibited. Information contained within is exempt from sharing under S43(2) of the Freedom of Information Act.

**HATTON**  
 TRAFFIC MANAGEMENT  
 Unit 10b, Brunswick Industrial Estate  
 Brunswick Village,  
 Newcastle Upon Tyne NE13 7BA  
 Tel: 0191 2368060 Fax: 0191 2362035  
 andrewross@hattontraffic.co.uk

**Project Details :**  
 Stockton and Darlington Railway  
 200 Event  
 Closure of Bishopston Lane on  
 Stockton Station approach. Allow  
 access to Hackworth Court

**Client:** Stockton Darlington and Durham Councils  
**Project:** Stockton and Darlington Railway 200 Event  
**Drawn By:** Andrew Ross  
**Checked By:** Wayne Robinson  
**Date:** 8th July 2025  
**Drawing Reference No:**  
 4007/25/215/AR24.1 Day 3 Ref 24

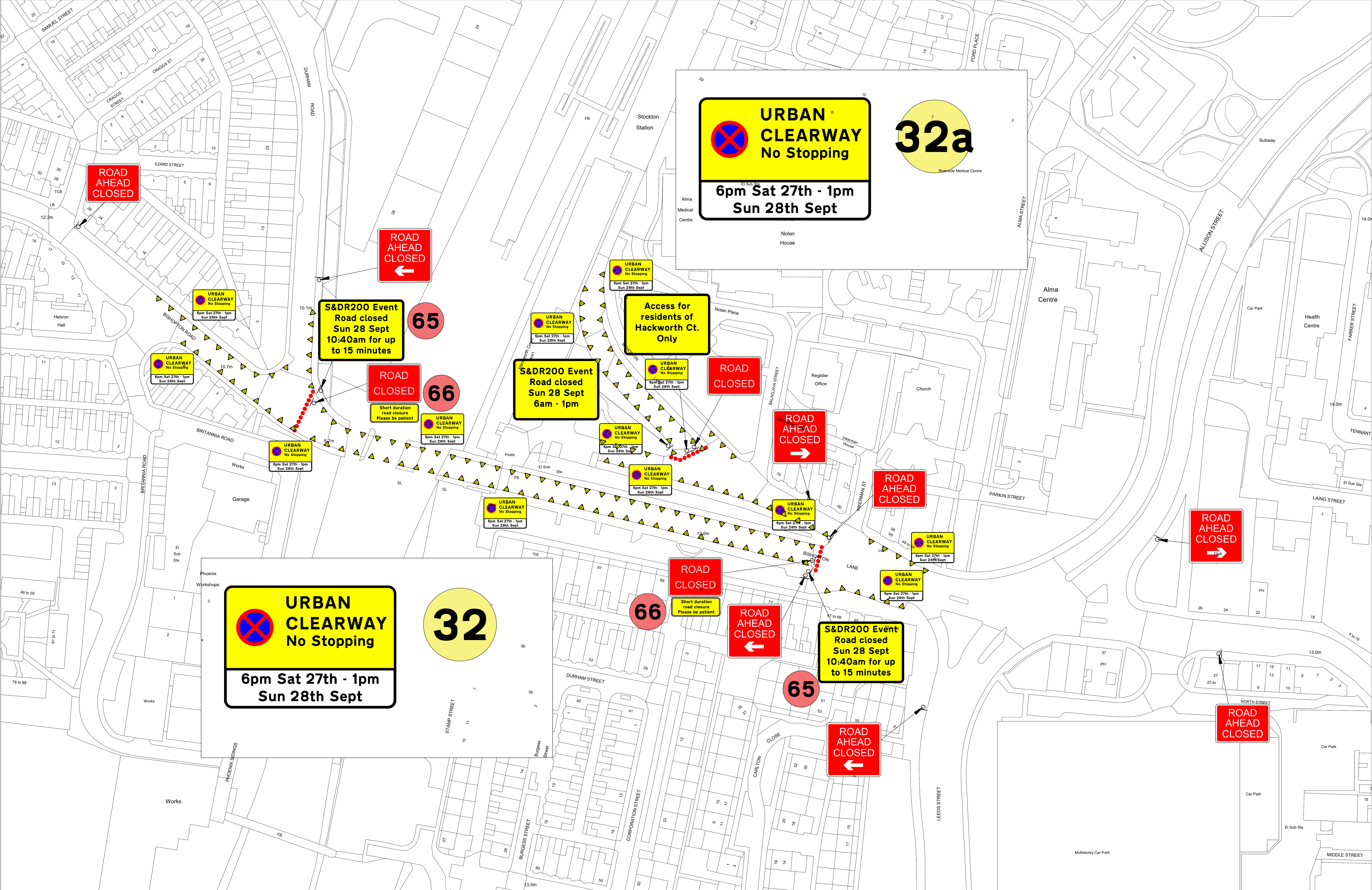

**Reproduction & Copyright Notice**  
 ©Hatton Traffic Management Limited 2025.  
 This document is the intellectual and physical property of Hatton Traffic Management Limited. All forms of reproduction are strictly prohibited without the prior approval of the author. Forwarding to third parties or use of this drawing by a third party/alternative contractor or authority is prohibited. Unauthorised reproduction or use may lead to prosecution or civil proceedings. Hatton Traffic Management Limited reserve the right to seek reparation for infringement or loss of income.  
 Use of digital mapping is by kind permission of Ordnance Survey Crown Copyright © Under the contractors use scheme.  
**Freedom of Information Act**  
 This document contains confidential and proprietary information. Unauthorised disclosure, copying or editing is prohibited. Information contained within is exempt from sharing under S43(2) of the Freedom of Information Act.

**HATTON**  
 TRAFFIC MANAGEMENT  
 Unit 10b, Brunswick Industrial Estate  
 Brunswick Village,  
 Newcastle Upon Tyne NE13 7BA  
 Tel: 0191 2368060 Fax: 0191 2362035  
 andrewross@hattontraffic.co.uk

**Project Details :**  
 Stockton and Darlington Railway  
 200 Event  
 Short duration closure of Bishopston  
 Lane from Bishopston Road to Prince  
 Regent Street

**Client:** Stockton Darlington and Durham Councils  
**Project:** Stockton and Darlington Railway 200 Event  
**Drawn By:** Andrew Ross  
**Checked By:** Wayne Robinson  
**Date:** 1st July 2025  
**Drawing Reference No:**  
 4007/25/215/AR23.2 Day 3 Ref 23



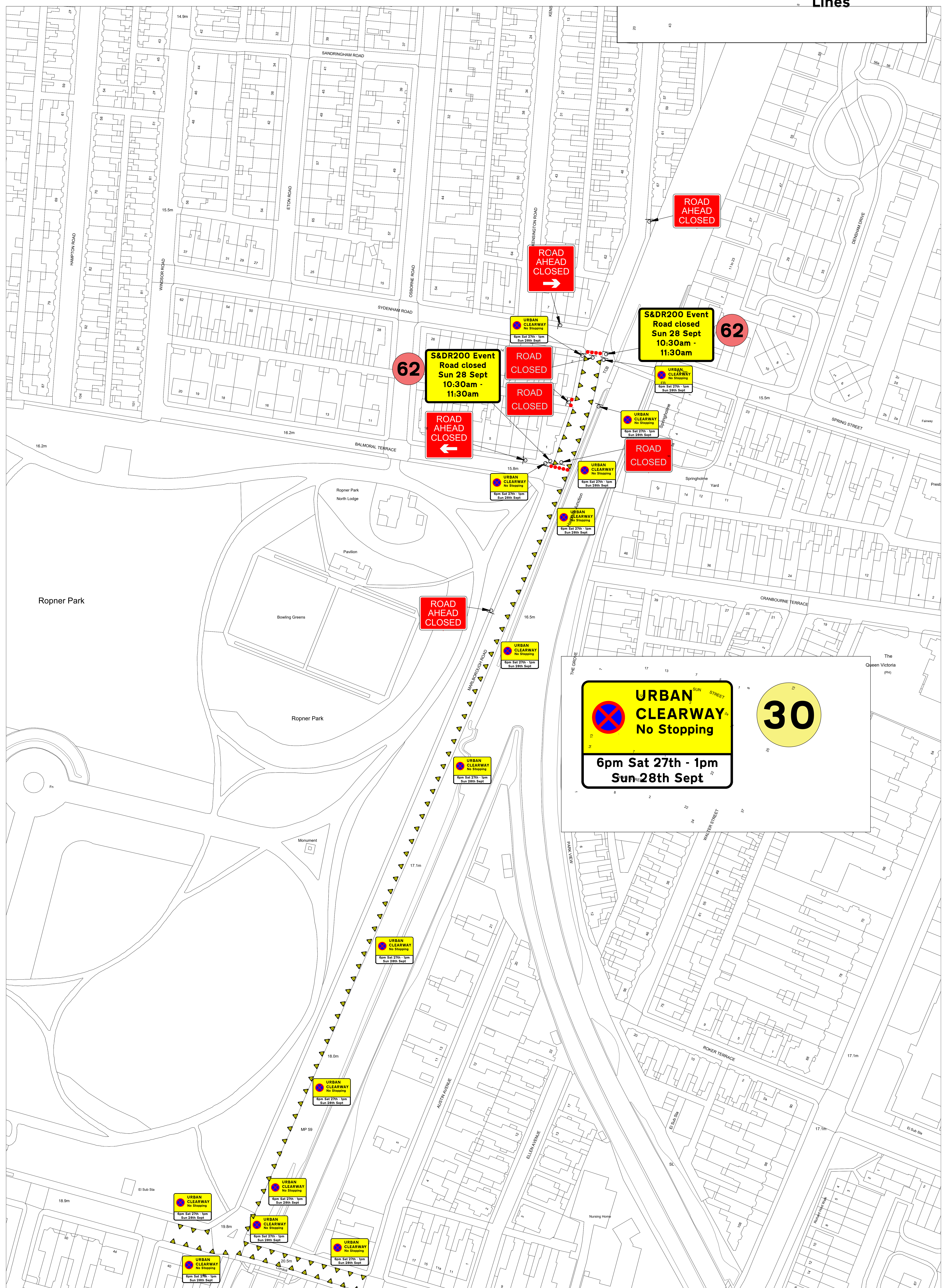

**Reproduction & Copyright Notice**  
 Hatton Traffic Management Limited 2025.  
 This document is the intellectual and physical property of Hatton Traffic Management Limited.  
 All forms of reproduction are strictly prohibited without the prior approval of the author. Forwarding to third parties or use of this drawing by a third party/alternative contractor or authority is prohibited. Unauthorised reproduction or use may lead to prosecution or civil proceedings. Hatton Traffic Management Limited reserve the right to seek reparation for infringement or loss of income.  
 Use of digital mapping is by kind permission of Ordnance Survey Crown Copyright © Under the contractors use scheme.  
 Freedom of Information Act.  
 This document contains confidential and proprietary information. Unauthorised disclosure, copying or editing is prohibited. Information contained within is exempt from sharing under 54(2) of the Freedom of Information Act.

**HATTON**  
 TRAFFIC MANAGEMENT  
 Unit 10b, Brunswick Industrial Estate  
 Brunswick Village,  
 Newcastle Upon Tyne NE13 7BA  
 Tel: 0191 2368060 Fax: 0191 2362035  
 andrewross@hattontraffic.co.uk

**Project Details:**  
 Stockton and Darlington Railway 200 Event  
 Closure of Marlborough Road from  
 Balmoral Terrace to Sydenham Road

**Client:** Stockton Darlington and Durham Councils  
**Project:** Stockton and Darlington Railway 200 Event  
**Drawn By:** Andrew Ross  
**Checked By:** Wayne Robinson  
**Date:** 5th June 2025  
**Drawing Reference No.:** 4007/25/215/AR19.1 Day 3 Ref 19

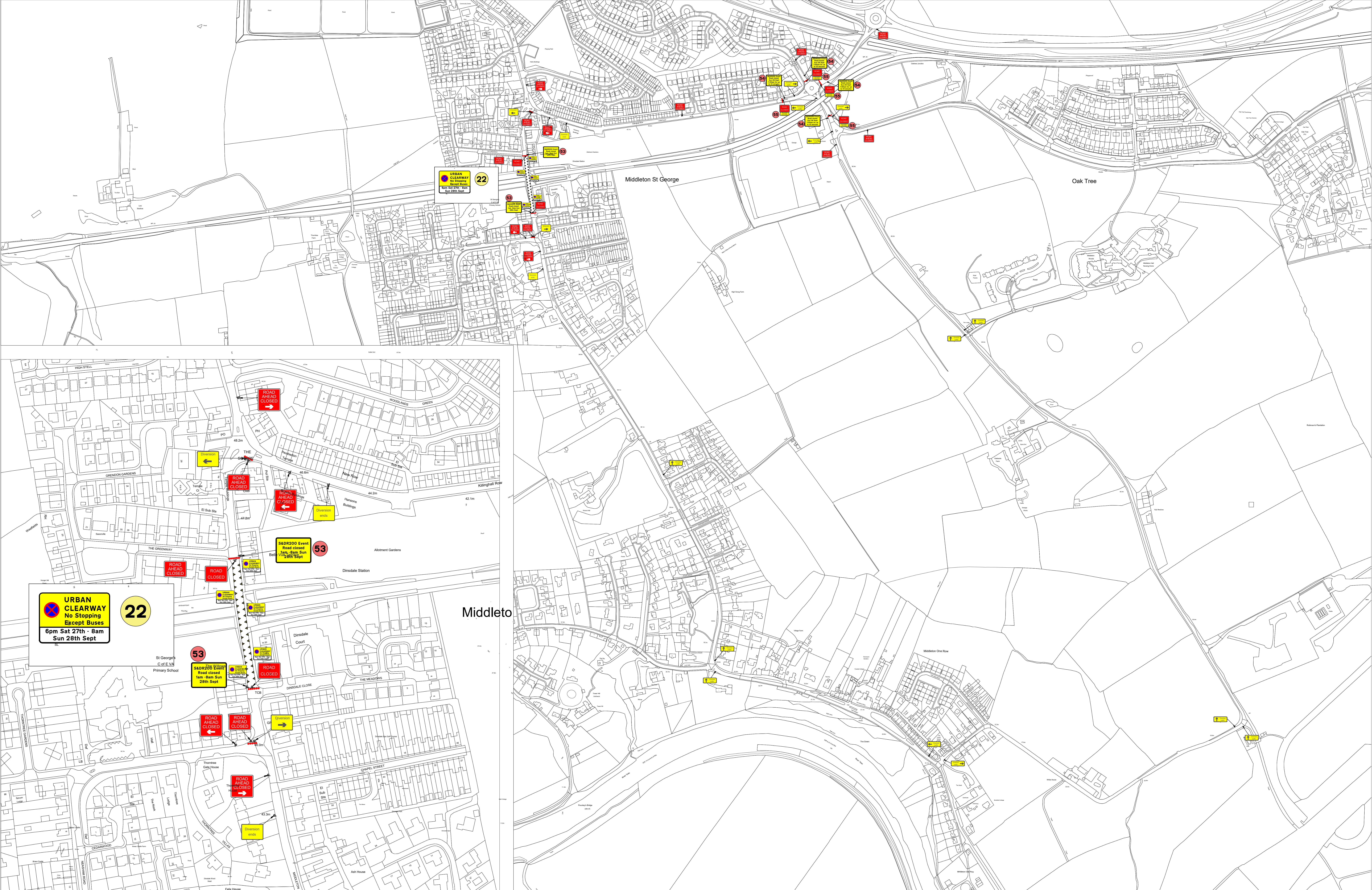

**Reproduction & Copyright Notice**  
 ©Hatton Traffic Management Limited 2025.  
 This document is the intellectual and physical property of Hatton Traffic Management Limited.  
 All forms of reproduction are strictly prohibited without the prior approval of the author. Forwarding to third parties or use of this drawing by a third party/alternative contractor or authority is prohibited. Unauthorised reproduction or use may lead to prosecution or civil proceedings. Hatton Traffic Management Limited reserve the right to seek reparation for infringement or loss of income.  
 Use of digital mapping is by kind permission of Ordnance Survey Crown Copyright © Under the contractors use scheme.  
**Freedom of Information Act**  
 This document contains confidential and proprietary information. Unauthorised disclosure, copying or editing is prohibited. Information contained within is exempt from sharing under S43(2) of the Freedom of Information Act.

**HATTON**  
 TRAFFIC MANAGEMENT  
 Unit 10b, Brunswick Industrial Estate  
 Brunswick Village,  
 Newcastle Upon Tyne NE13 7BA  
 Tel: 0191 2368060 Fax: 0191 2362035  
 andrewross@hattontraffic.co.uk

**Project Details :**  
 Stockton and Darlington Railway  
 200 Event  
 Closure of Middleton Lane from  
 Dinsdale Close – The Greenway

**Client:** Stockton Darlington and Durham Councils  
**Project:** Stockton and Darlington Railway 200 Event  
**Drawn By:** Andrew Ross  
**Checked By:** Wayne Robinson  
**Date:** 1st July 2025  
**Drawing Reference No:**  
 4007/25/215/AR03.2 Day 3 Ref 1

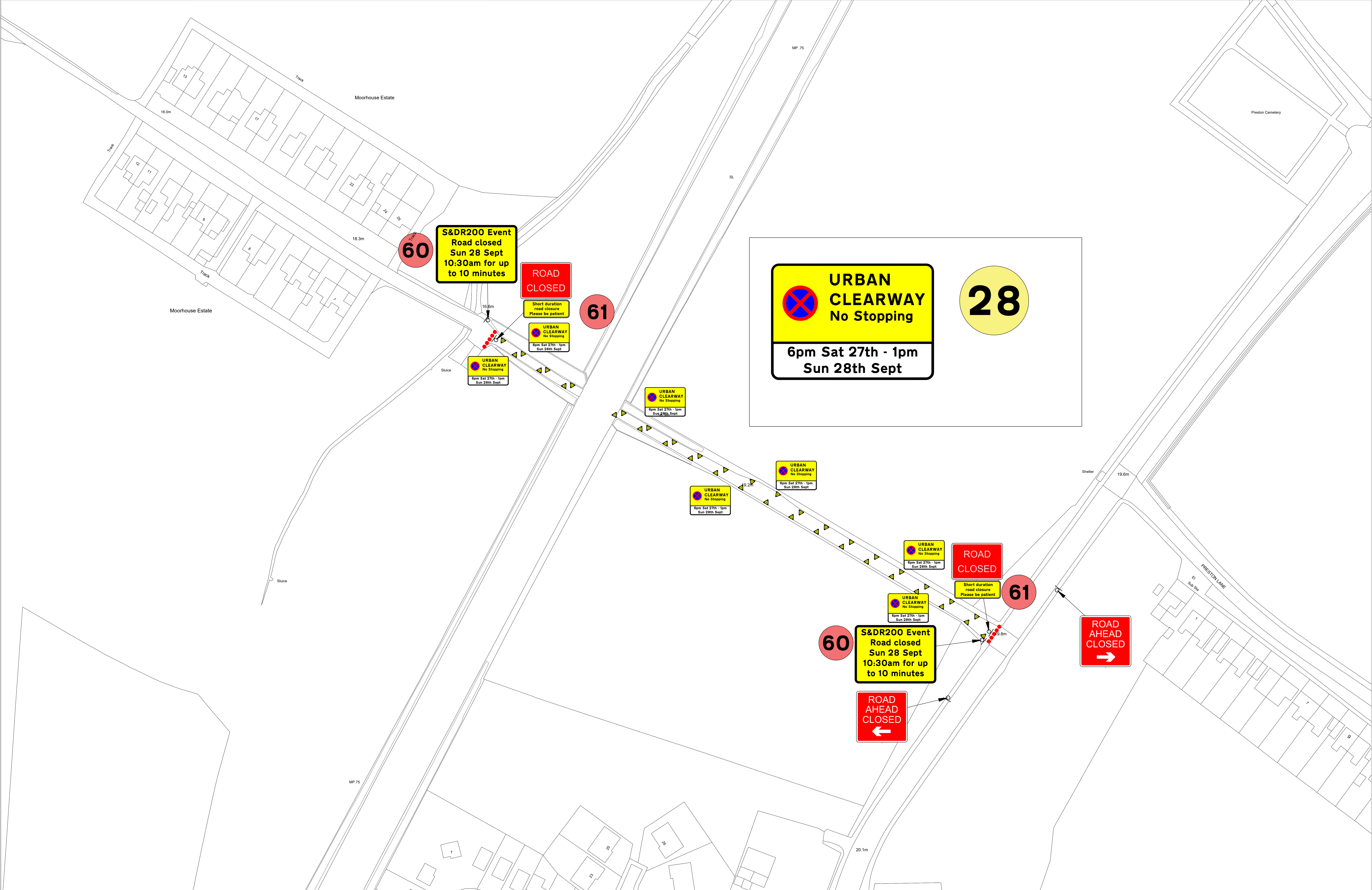

**Reproduction & Copyright Notice**  
 ©Hatton Traffic Management Limited 2025.  
 This document is the intellectual and physical property of Hatton Traffic Management Limited. All forms of reproduction are strictly prohibited without the prior approval of the author. Forwarding to third parties or use of this drawing by a third party/alternative contractor or authority is prohibited. Unauthorised reproduction or use may lead to prosecution or civil proceedings. Hatton Traffic Management Limited reserve the right to seek reparation for infringement or loss of income.  
 Use of digital mapping is by kind permission of Ordnance Survey Crown Copyright © Under the contractors use scheme.  
**Freedom of Information Act**  
 This document contains confidential and proprietary information. Unauthorised disclosure, copying or editing is prohibited. Information contained within is exempt from sharing under S43(2) of the Freedom of Information Act.

**HATTON**  
 TRAFFIC MANAGEMENT  
 Unit 10b, Brunswick Industrial Estate  
 Brunswick Village,  
 Newcastle Upon Tyne NE13 7BA  
 Tel: 0191 2368060 Fax: 0191 2362035  
 andrewross@hattontraffic.co.uk

**Project Details :**  
 Stockton and Darlington Railway  
 200 Event  
 Short duration closure of Moorhouse  
 Estate at junction with Yarm Rd

**Client:** Stockton Darlington and Durham Councils  
**Project:** Stockton and Darlington Railway 200 Event  
**Drawn By:** Andrew Ross  
**Checked By:** Wayne Robinson  
**Date:** 5th June 2025  
**Drawing Reference No:**  
 4007/25/215/AR15.1 Day 3 Ref 15

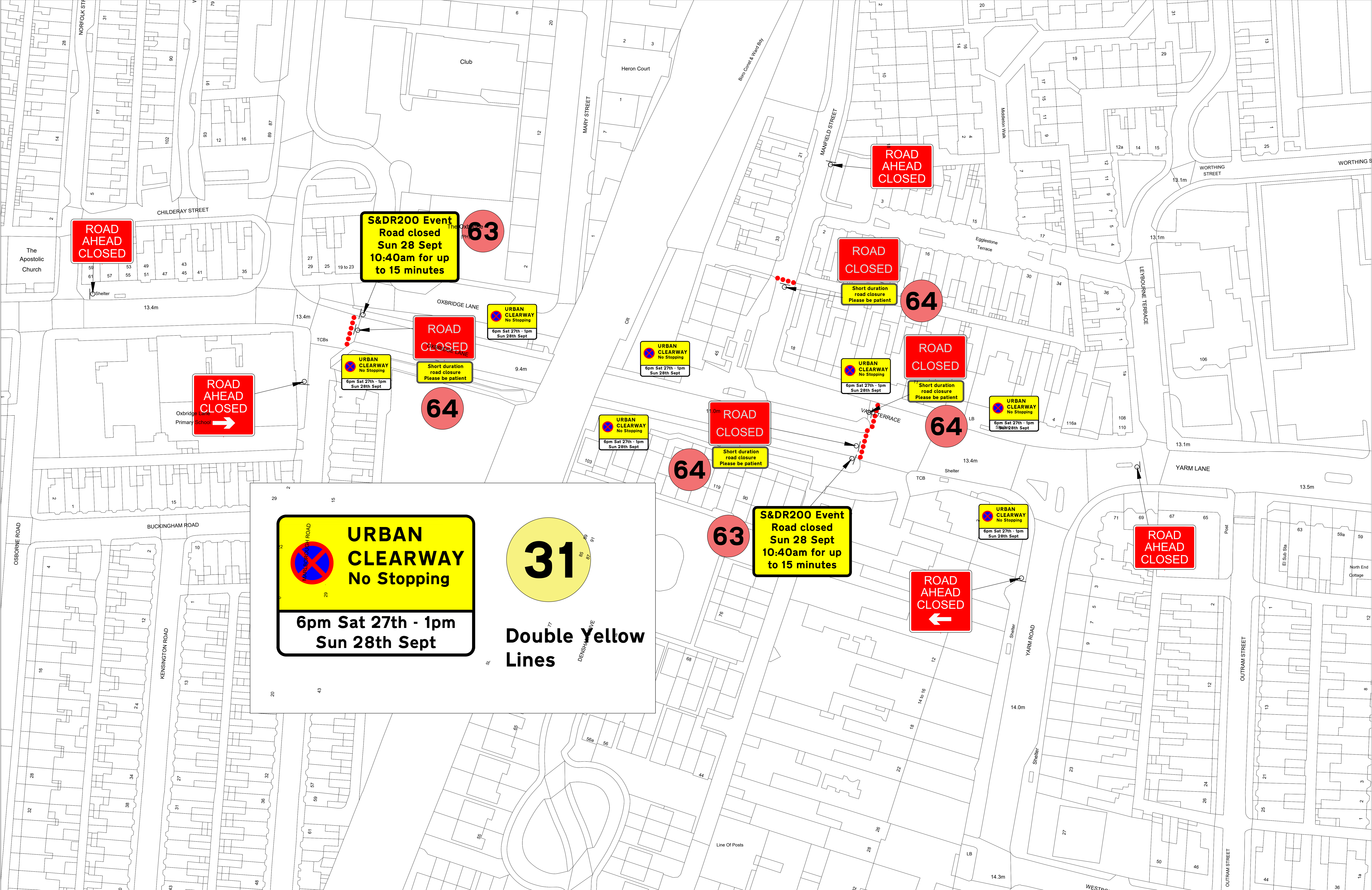

**Reproduction & Copyright Notice**  
 ©Hatton Traffic Management Limited 2025.  
 This document is the intellectual and physical property of Hatton Traffic Management Limited.  
 All forms of reproduction are strictly prohibited without the prior approval of the author. Forwarding to third parties or use of this drawing by a third party/alternative contractor or authority is prohibited. Unauthorised reproduction or use may lead to prosecution or civil proceedings. Hatton Traffic Management Limited reserve the right to seek reparation for infringement or loss of income.  
 Use of digital mapping is by kind permission of Ordnance Survey Crown Copyright © Under the contractors use scheme.  
**Freedom of Information Act**  
 This document contains confidential and proprietary information. Unauthorised disclosure, copying or editing is prohibited. Information contained within is exempt from sharing under S43(2) of the Freedom of Information Act.

**HATTON**  
 TRAFFIC MANAGEMENT  
 Unit 10b, Brunswick Industrial Estate  
 Brunswick Village,  
 Newcastle Upon Tyne NE13 7BA  
 Tel: 0191 2368060 Fax: 0191 2362035  
 andrewross@hattontraffic.co.uk

**Project Details :**  
 Stockton and Darlington Railway  
 200 Event  
 Short duration closure of Oxbridge  
 Lane at junction with Yarm Road/Varo  
 Terrace to Marlborough Road

**Client:** Stockton Darlington and Durham Councils  
**Project:** Stockton and Darlington Railway 200 Event  
**Drawn By:** Andrew Ross  
**Checked By:** Wayne Robinson  
**Date:** 5th June 2025  
**Drawing Reference No:**  
 4007/25/215/AR20.1 Day 3 Ref 20

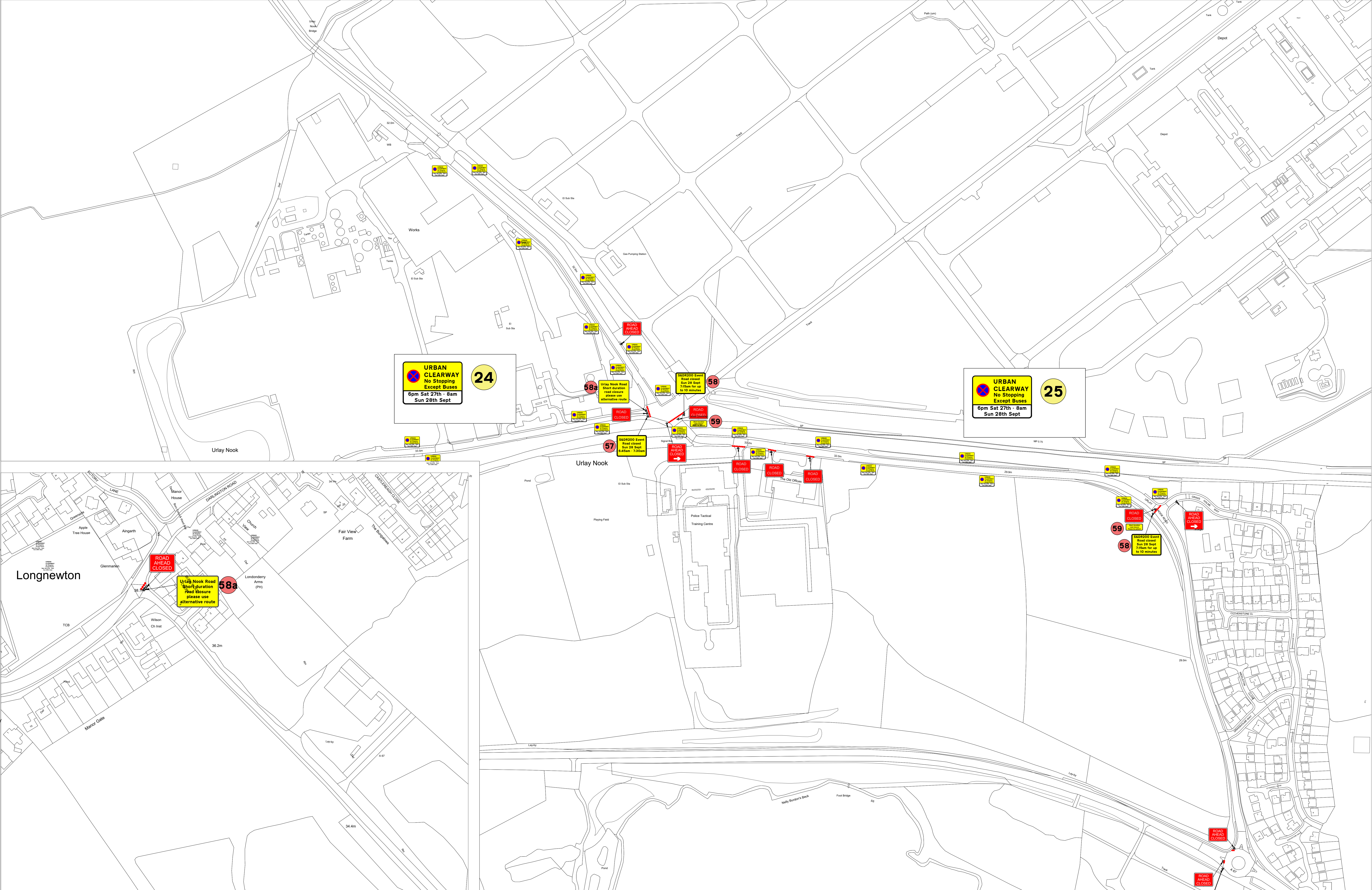

**Reproduction & Copyright Notice**  
 ©Hatton Traffic Management Limited 2025.  
 This document is the intellectual and physical property of Hatton Traffic Management Limited. All forms of reproduction are strictly prohibited without the prior approval of the author. Forwarding to third parties or use of this drawing by a third party/alternative contractor or authority is prohibited. Unauthorised reproduction or use may lead to prosecution or civil proceedings. Hatton Traffic Management Limited reserve the right to seek reparation for infringement or loss of income.  
 Use of digital mapping is by kind permission of Ordnance Survey Crown Copyright © Under the contractors use scheme.  
**Freedom of Information Act.**  
 This document contains confidential and proprietary information. Unauthorised disclosure, copying or editing is prohibited. Information contained within is exempt from sharing under S43(2) of the Freedom of Information Act.

**HATTON**  
 TRAFFIC MANAGEMENT  
 Unit 10b, Brunswick Industrial Estate  
 Brunswick Village,  
 Newcastle Upon Tyne NE13 7BA  
 Tel: 0191 2368060 Fax: 0191 2362035  
 andrewross@hattontraffic.co.uk

**Project Details :**  
 Stockton and Darlington Railway  
 200 Event  
 Short duration closure of Urley Nook  
 Road from Grassholme Way to Level  
 Crossing

**Client:** Stockton Darlington and Durham Councils  
**Project:** Stockton and Darlington Railway 200 Event  
**Drawn By:** Andrew Ross  
**Checked By:** Wayne Robinson  
**Date:** 31st July 2025  
**Drawing Reference No:**  
 4007/25/215/AR11.3 Day 3 Ref 11

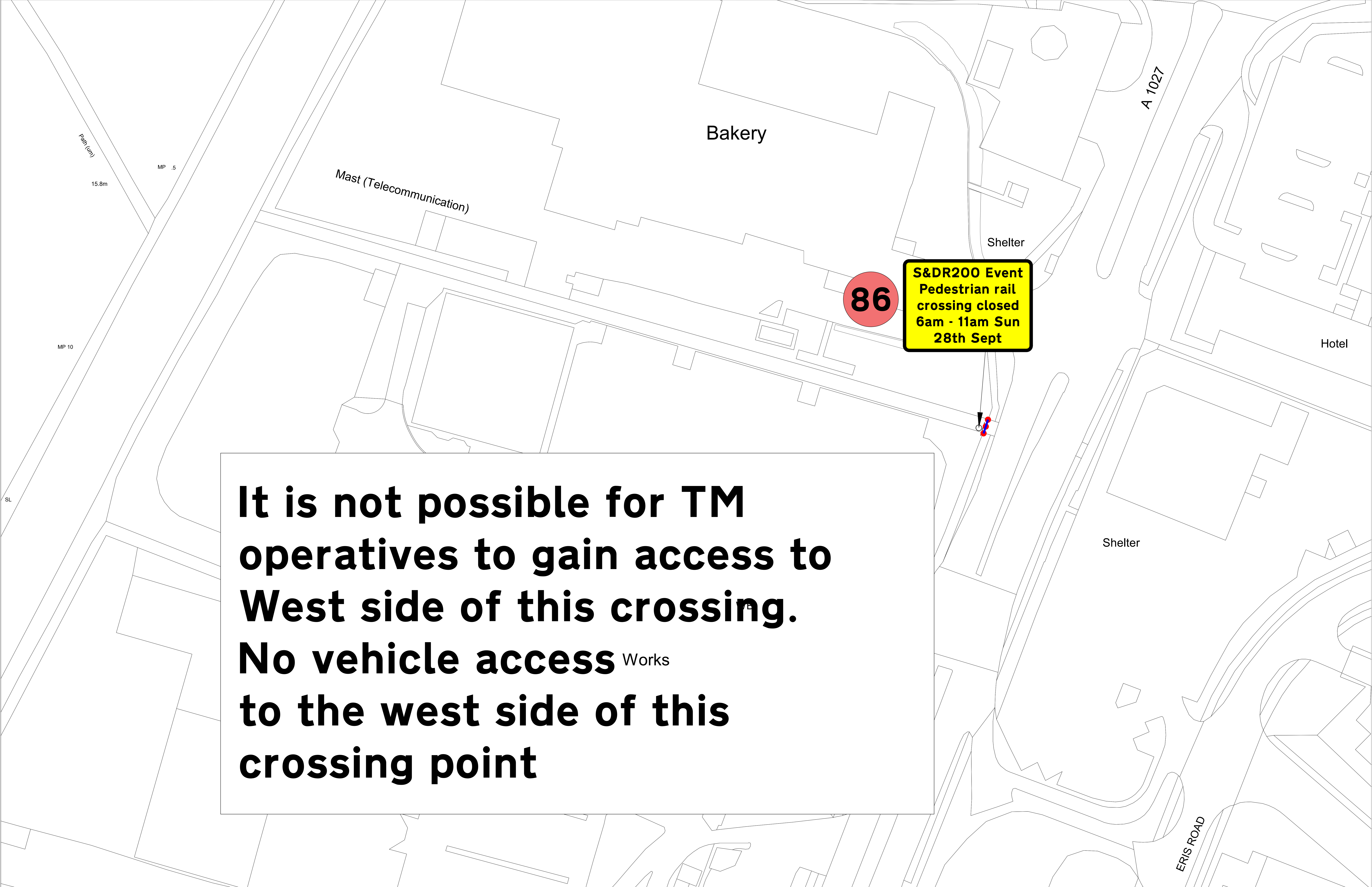

86

**S&DR200 Event  
Pedestrian rail  
crossing closed  
6am - 11am Sun  
28th Sept**

**It is not possible for TM  
operatives to gain access to  
West side of this crossing.  
No vehicle access Works  
to the west side of this  
crossing point**

**Reproduction & Copyright Notice**  
©Hatton Traffic Management Limited 2025.  
This document is the intellectual and physical property of Hatton Traffic Management Limited.  
All forms of reproduction are strictly prohibited without the prior approval of the author. Forwarding to third parties or use  
of this drawing by a third party/alternative contractor or authority is prohibited. Unauthorised reproduction or use may  
lead to prosecution or civil proceedings. Hatton Traffic Management Limited reserve the right to seek reparation for  
infringement or loss of income.  
Use of digital mapping is by kind permission of Ordnance Survey Crown Copyright © Under the contractors use scheme.  
**Freedom of Information Act**  
This document contains confidential and proprietary information. Unauthorised disclosure, copying or editing is  
prohibited. Information contained within is exempt from sharing under S43(2) of the Freedom of Information Act.

**HATTON**  
TRAFFIC MANAGEMENT  
Unit 10b, Brunswick Industrial Estate  
Brunswick Village,  
Newcastle Upon Tyne NE13 7BA  
Tel: 0191 2368060 Fax: 0191 2362035  
andrewross@hattontraffic.co.uk

**Project Details :**  
Stockton and Darlington Railway  
200 Event  
Closure of Hartwell Lane Public  
Footpath & pedestrian level crossing

**Client:** Stockton Darlington and Durham Councils  
**Project:** Stockton and Darlington Railway 200 Event  
**Drawn By:** Andrew Ross  
**Checked By:** Wayne Robinson  
**Date:** 5th June 2025  
**Drawing Reference No:**  
4007/25/215/AR16.1 Day 3 Ref 16

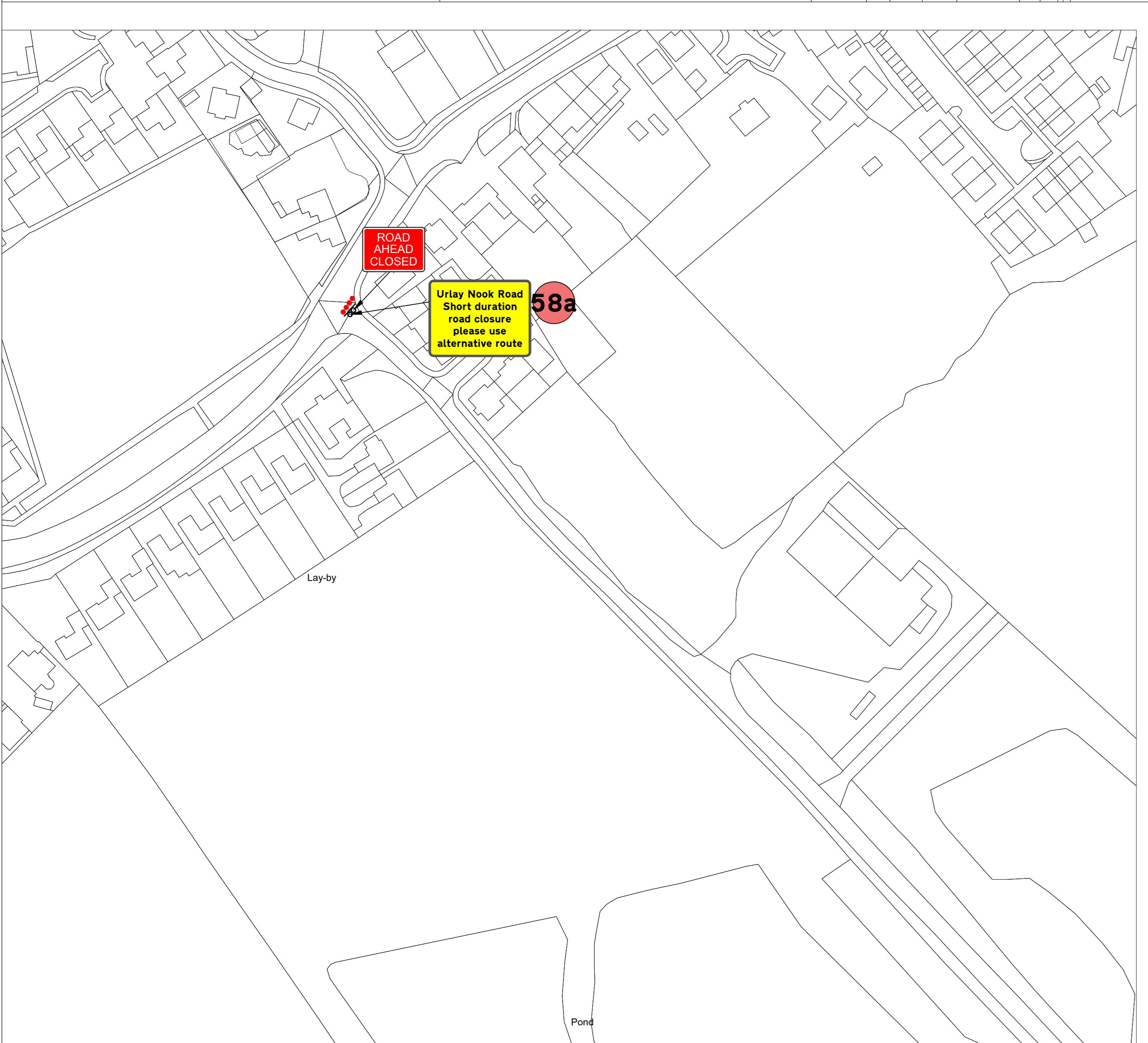
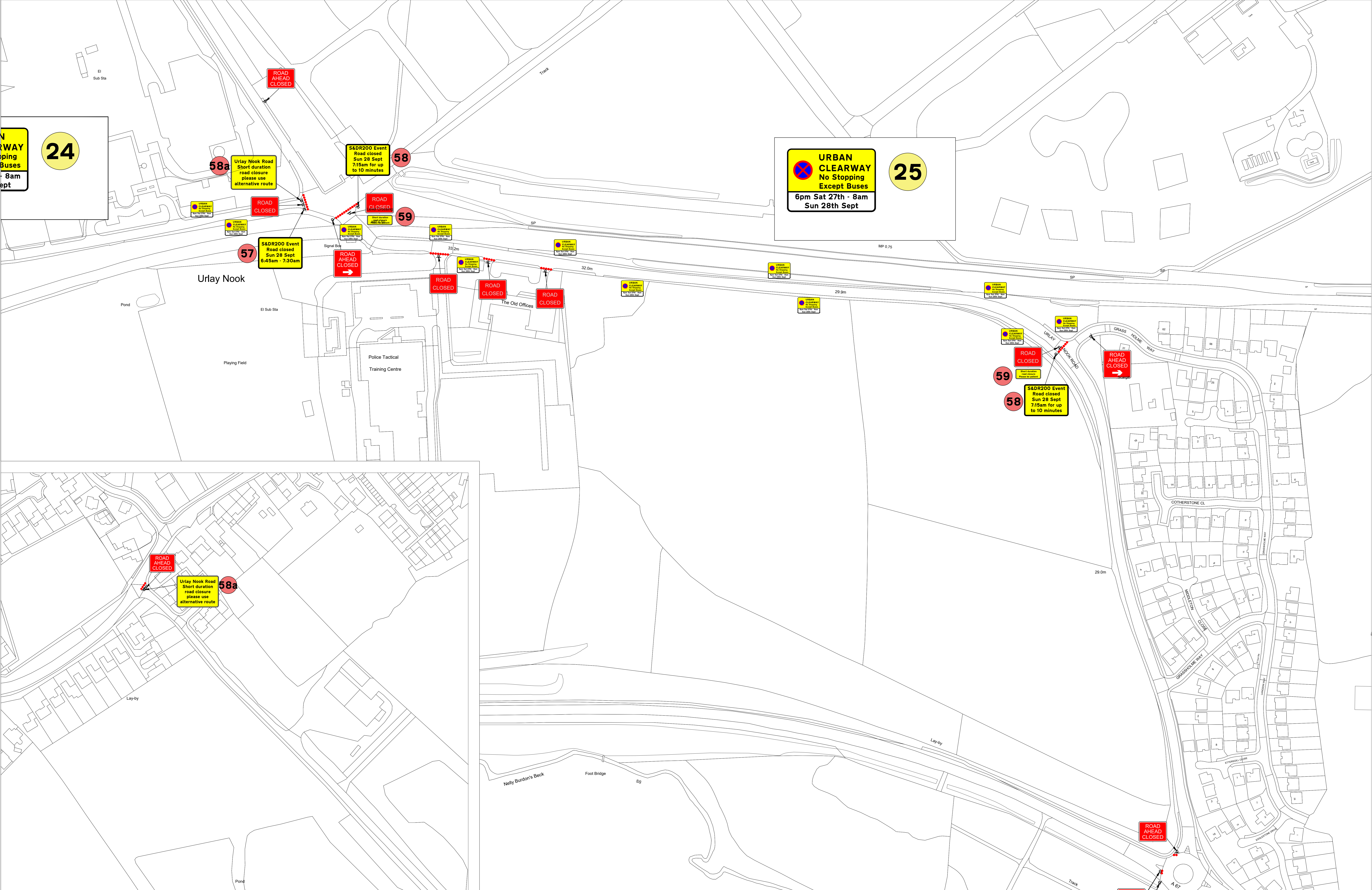

**Reproduction & Copyright Notice**  
 ©Hatton Traffic Management Limited 2025.  
 This document is the intellectual and physical property of Hatton Traffic Management Limited. All forms of reproduction are strictly prohibited without the prior approval of the author. Forwarding to third parties or use of this drawing by a third party/alternative contractor or authority is prohibited. Unauthorised reproduction or use may lead to prosecution or civil proceedings. Hatton Traffic Management Limited reserve the right to seek reparation for infringement or loss of income.  
 Use of digital mapping is by kind permission of Ordnance Survey Crown Copyright © Under the contractors use scheme.  
**Freedom of Information Act**  
 This document contains confidential and proprietary information. Unauthorised disclosure, copying or editing is prohibited. Information contained within is exempt from sharing under S43(2) of the Freedom of Information Act.

**HATTON**  
 TRAFFIC MANAGEMENT  
 Unit 10b, Brunswick Industrial Estate  
 Brunswick Village,  
 Newcastle Upon Tyne NE13 7BA  
 Tel: 0191 2368060 Fax: 0191 2362035  
 andrewross@hattontraffic.co.uk

**Project Details :**  
 Stockton and Darlington Railway  
 200 Event  
 Short duration closure of Urly Nook  
 Road from Grassholme Way to Level  
 Crossing

**Client:** Stockton Darlington and Durham Councils  
**Project:** Stockton and Darlington Railway 200 Event  
**Drawn By:** Andrew Ross  
**Checked By:** Wayne Robinson  
**Date:** 1st July 2025  
**Drawing Reference No:**  
 4007/25/215/AR11.2 Day 3 Ref 11

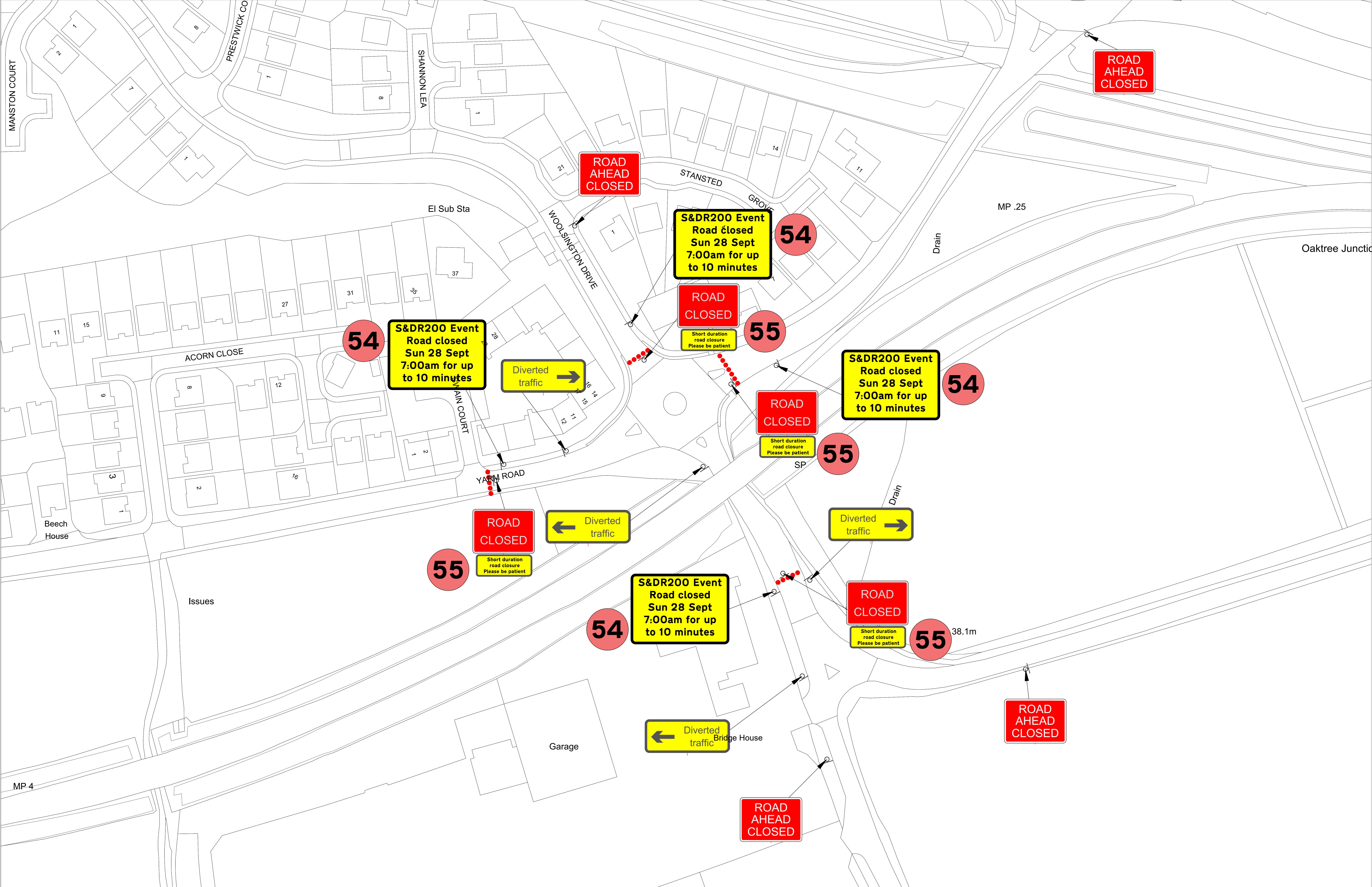

**Reproduction & Copyright Notice**  
 ©Hatton Traffic Management Limited 2025.  
 This document is the intellectual and physical property of Hatton Traffic Management Limited. All forms of reproduction are strictly prohibited without the prior approval of the author. Forwarding to third parties or use of this drawing by a third party/alternative contractor or authority is prohibited. Unauthorised reproduction or use may lead to prosecution or civil proceedings. Hatton Traffic Management Limited reserve the right to seek reparation for infringement or loss of income.  
 Use of digital mapping is by kind permission of Ordnance Survey Crown Copyright © Under the contractors use scheme.  
**Freedom of Information Act**  
 This document contains confidential and proprietary information. Unauthorised disclosure, copying or editing is prohibited. Information contained within is exempt from sharing under S43(2) of the Freedom of Information Act.

**HATTON**  
 TRAFFIC MANAGEMENT  
 Unit 10b, Brunswick Industrial Estate  
 Brunswick Village,  
 Newcastle Upon Tyne NE13 7BA  
 Tel: 0191 2368060 Fax: 0191 2362035  
 andrewross@hattontraffic.co.uk

**Project Details :**  
 Stockton and Darlington Railway  
 200 Event  
 Yarm Road Rail bridge, Short duration  
 closure at all approaches to  
 roundabout and bridge

**Client:** Stockton Darlington and Durham Councils  
**Project:** Stockton and Darlington Railway 200 Event  
**Drawn By:** Andrew Ross  
**Checked By:** Wayne Robinson  
**Date:** 5th June 2025  
**Drawing Reference No:** 4007/25/215/AR03.1 Day 3 Ref 3